

*Features:

- HALEd patent optics design, similar to halogen light effect
- Easy and quick installation
- Ultra-thin design, with a height of only 31.4mm
- $PF > 0.85$, flicker free, follows new ErP
- Dimmable or Dim to warm halogen function by triac dimmer
4.8W HALEd downlight replace 50W halogen lamp
- CRI 95, $R9 > 90$
- Low UGR
- Peak luminous intensity is 1.25 times of parallel products
- Suitable for all kinds of unenclosed luminaire
- Metal structure, excellent heat dissipation
- Lifespan 40,000 hrs, 5 years warranty
- High energy efficiency



CE RoHS ErP
Surface ring: Nickel

Applications

- Residential application and hotel lighting.
- Commercial lighting like restaurants, bars, cafes, etc.

Technical data

Part No.	Type of installation
DCK002W05-49042/49047	Double wiring
DCW002W05-49043/49048	

Electrical specifications	
Wattage (W)	4.8W
AC input voltage (V)	AC200V-240V
Frequency (Hz)	50/60Hz
Flicker metric PST	0.023
Total harmonic distortion (THD)	27%
Max. no. of lamps on B16A circuit breaker	420
Max. no. of lamps on C16A circuit breaker	420

Photometric specifications	
Color temperature (CCT)	2700K/3000K
Chromaticity coordinate (x/ y)	2700K: 0.459/ 0.412
Useful luminous flux (lm)	350lm \pm 5%
UGR	≤ 19

Power factor	> 0.75
Current	27mA
DC output voltage (V)	-
Stroboscopic effect metric SVN	0.25
Dimmable	Dimmable
Max. no. of lamps on C10A circuit breaker	240

CRI/ R9	95/ 90(Min.)
Standard deviation of colour	$\leq 3SDCM$
Luminous efficiency (lm/W)	86lm/ W (ERP)

Photometric Information

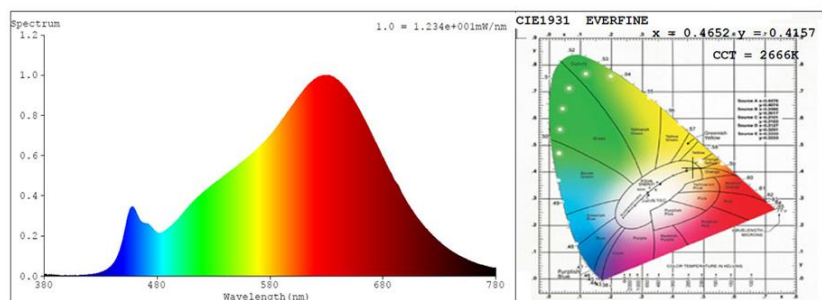

EAN	Colour	Beam angle	Peak Luminous intensity
-----	--------	------------	-------------------------

49037(2700K)	White	24°	1050cd
49038(3000K)			

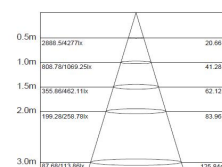
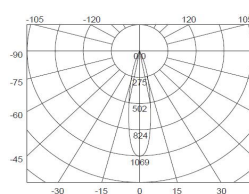

49032(2700K)	White	36°	800cd
49033(3000K)			

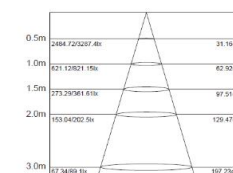
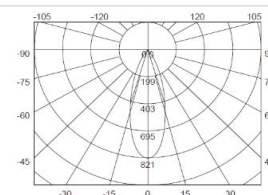

Mechanical specifications

Housing material	Aluminium
Optical cover/ lens material	Al Reflector+PC+Glass
Width/ diameter	85mm
Product weight	120g

Lifespan

Number of switching cycles	100,000-
L80/B10 service life at 25°C	40,000 hrs
Warranty	5 Years

Application parameters

Working temperature range	-20~+50°C
---------------------------	-----------

Package

Individual package length	100mm
Individual package height	45mm

Housing Colour	Titanium
Length/ diameter	68mm
Height	31.4mm

L70/B50 service life at 25°C	50,000 hrs
L90/B10 service life at 25°C	20,000 hrs

Storage temperature range	-20~+70°C
---------------------------	-----------

Shipping box height	575mm
Shipping box height	245mm

Individual package width	90mm	Shipping box width	480mm
Gross weight (single item)	120g	Packaging unit	100pcs
Driver	Internal	Gross weight (Shipping box)	14kgs

Technical Drawings (mm)

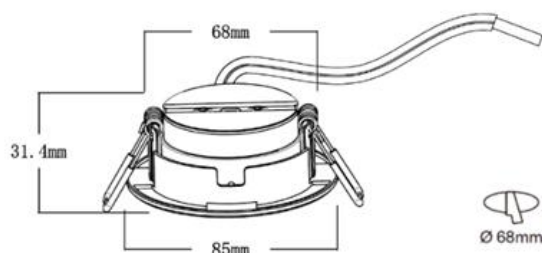

Note: Height between the module and roof should be no less than 10cm for heat dissipation purpose for installation.

Package



Inner Box 100*90*45mm



Inner Carton 465*110*110mm(10PCS)



Shipping Carton 575*480*245mm(100PCS)

Installation /Mounting:

Please read the entire instruction manual before using the product and reserve it for future reference. We reserve the right for any error in text or image and any necessary change made to technical data. If you have any question regarding technical problems, please contact our Customer Services.

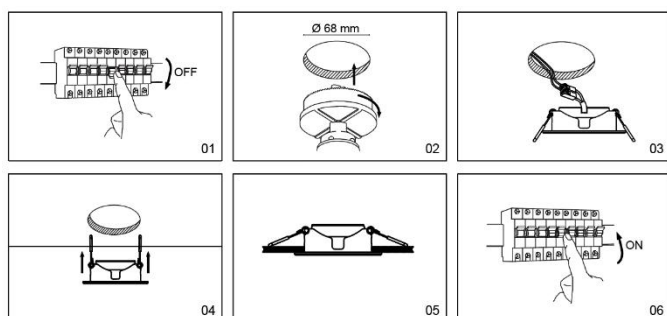

Cautions:

- Don't touch the lamp when it is lighted
- Don't use it in enclosed luminaire
- Power off before replacement
- Do not in violation of any fire regulations when using
- Consult professional electricians for technical support
- If the cable is damaged, it must be replaced by the manufacturer and its service agent, or qualified person in order to avoid hazards.